

	'L' Chamber (P')	ø1/2" Hose (P')	ø3/4" Hose (P')	GPO/GSO/GNO (W')
4"	SF-4ABS	SF-4ABS-H.5	SF-4ABS-H.75	-
6"	SF-6ABS	SF-6ABS-H.5	SF-6ABS-H.75	-
10"	SF-10ABS	SF-10ABS-H.5	SF-10ABS-H.75	SF-9ABS
20"	SF-20ABS	SF-20ABS-H.5	SF-20ABS-H.75	SF-19ABS
30"	SF-30ABS	SF-30ABS-H.5	SF-30ABS-H.75	-
40"	SF-40ABS	SF-40ABS-H.5	SF-40ABS-H.75	-

\*Mini-Canister type

NO	DESCRIPTION	QTY	GPO/GSO	'L' Chamber	Hose
1	Canister ABS	4"	1	99-2191	99-2191-2
				99-2192	99-2192-2
				99-2193	99-2193-2
				99-2194	99-2194-2
				99-2195	99-2195-2
2	Outlet Cap PVC	1	-	99-0272	-
				99-2196	99-2196-2
3	O-Ring EPDM	1	22-2319	22-0905	-
4	Spring Vinyl Coated SS	1	-	77-0301-1	-
5	Spring Guard Cap CPVC	1	-	77-0911	-
6	Adapter Hose CPVC	1/2"	1	-	33-0503
				3/4"	-

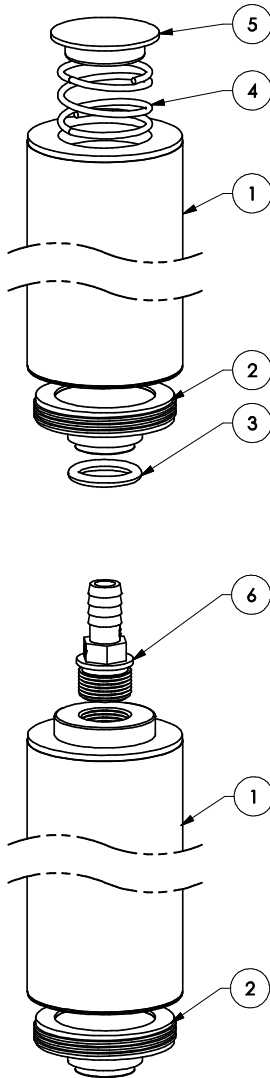

Carbon Media Bulletin M-305  
Resin Media Bulletin R-208

**Installations Configuration**

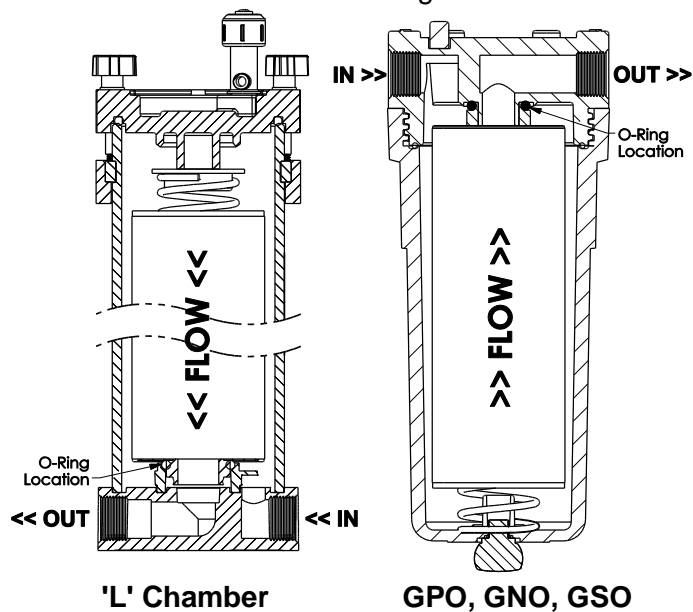

Chemicals and Plating Product Bulletin	M-305
Potable Water Product Bulletin	M-310