

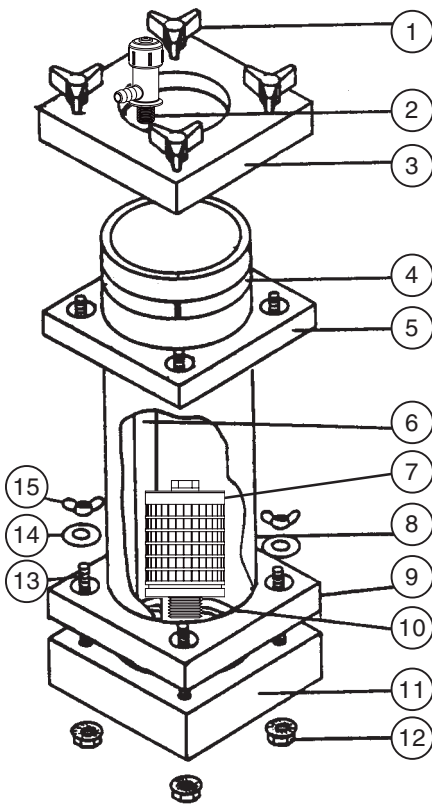

BULK CARBON CHAMBER & RESIN RECLAMATION CHAMBER

Refer to Bulletin R-201 (resin) and Operation and Service Guides O-300 (carbon) or O-480 (resin) and Master Price List F-800.

MODELS	PRICE CODE NOS.
PCL10CR ¾	78-1631
PCL20CR ¾	78-1632
PCL30CR ¾	78-1633
CL10CR ¾	78-1631C
CL20CR ¾	78-1632C
CL30CR ¾	78-1633C



ITEM	DESCRIPTION	MODELS	
		PCL	CL
PART NUMBERS			
1	Plastic knob & threaded assembly ¼"-20 (4 req'd)	11-0298	
2	Vent valve, ¼" NPT - polypropylene	33-8108 PP	
2A	"O"-ring - EPDM (standard) - Viton (optional)	22-0870 22-0870 V	
3	Cover - CPVC	88-0948	
3A	"O"-ring - EPDM (standard) - Viton (optional)	22-0283 22-0328	
4	Retaining collar - CPVC (2 req'd)	88-1098	
5	Hold down bracket - CPVC, upper	88-1099	
6	Percolator tube - CPVC 10" chamber 20" chamber 30" chamber	88-0778 88-0778A 88-0778B	
7 ³	Filter nozzle, 250 micron - polypropylene	33-1951-1	
8	Shell - clear PVC (PCL), CPVC (CL) 10" chamber 20" chamber 30" chamber	88-0786 1C 88-0787 1C 88-0788 1C	88-0786 1 88-0787 1 88-0788 1
9	Hold down bracket, lower - PVC	88-2739	
10 ¹	Base gasket - EPDM (standard) - Viton (optional)	22-0275 22-0306	
11 ²	Base, ¾" NPT ports - CPVC	88-0979 1	
12	Whizz locknut, ¼"-20 - stainless steel (8 req'd)	11-0103	
13	Threaded rod, ¼"-20 x 4½" - stainless steel (4 req'd)	77-9947	
14	Flat washer ¼" - stainless steel (4 req'd)	11-0121	
15	Wing nut ¼"-20 - stainless steel (4 req'd)	11-0101	
Not shown			
16	Reducer bushing, ¾" x ½" NPT - CPVC (optional)	33-1131	
17	Vent valve hose, 4'	22-0913	
17A	Hose clamp	22-0912	

- 1 Recommended Spare Parts. Order carbon or resin separately.
 - 2 Chambers manufactured before 8/1/94 had ½" NPT bases. Order ¾" NPT bases with reducer bushings for replacement. Chambers manufactured before 1/02 use base 88-0979.
 - 3 Chambers manufactured before 1/02 require filter nozzle adapter 33-1952 solvent welded into base.
- 'AUL' Models (ABS & acrylic construction) have been replaced by 'PCL' (clear PVC & CPVC).

GRANULAR ACTIVATED CARBON		
10 or 50 lb. drums only		
8 x 30 Mesh 99.5% Sulfur Free (Standard)	LBS	P/C NO.
	10	99-0992
12 x 30 Mesh Sulfur Free (Acid Washed)	50	99-0995
	10	99-0993
	50	99-0996

RESIN	.25 cu.ft.	.5 cu.ft.	1.0 cu.ft.	10 or more cu.ft. (per cu.ft.)	
	PRICE CODE NUMBERS				
For Precious Metal Recovery	Alkaline	1314	1315	1316	1317
	Acid	1320	1321	1322	1323
For Deionizing Water Mixed Bed Resin (DWI)		1326	1327	1328	1329

When ordering, use Price Code Number to indicate quantity required.